



**SOCIETY FOR THE STUDY OF REPRODUCTION (SSR) 2012
 THE PENNSYLVANIA STATE UNIVERSITY
 ON-CAMPUS HOUSING RESERVATION REQUEST**

DESCRIPTION OF ACCOMMODATIONS:

A special package has been reserved for the *Society for the Study of Reproduction at* North Residence Hall for the program's duration. The rate is **\$60.00 per night, per person, single occupancy, or \$45.00 per night, per person, double occupancy at North Halls.** You may add a cot to the room for an additional fee of **\$20.00 per person, per night, which includes a meal plan.** Cots are reserved for guest 16 years of age or younger. Rooms are available beginning Saturday, August 10th through Thursday, August 16th. If you are interested in room for more than three (3) guests, please call our office for rates and additional information. We offer a limited number of these rooms.

Rooms are air-conditioned suites with two single beds in each room sharing a bathroom with an adjoining room. Each room is furnished with two single beds along with nightstands, dressers, and desks. A small combination microwave/refrigerator is also provided for your convenience. Housing amenities include daily maid service with linen to include towels, washcloths, pillows, sheets and bedspreads. We suggest you bring anything else that would make your stay more comfortable, such as an alarm clock, hangers, or extra blankets. Room rate includes a hot breakfast, Monday – Friday, in the Pollock Dining Commons located near Eastview Terrace. This is about a ten minute walk from North Halls. You will need to arrange for your own breakfast on August 11th and 12th.

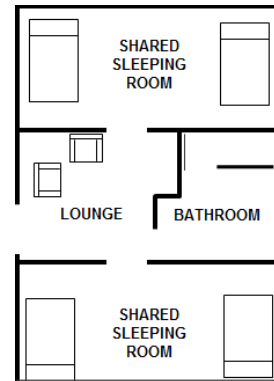

If anyone would like to request roommates for the adjoining room please indicate on the reservation request form. If no requests are made you will share a bathroom with another guest(s). Individuals will be assigned rooms by same gender.

Check-in will be conducted at the Commons Desk Located in Warnock Commons. Warnock Commons is located in the North Halls housing area (off of Park Avenue and Shortlidge Road).

We will be offering parking passes at the Warnock Commons desk upon check-in for \$21. Please indicate on the reservation form if you will need a parking pass.

TO RESERVE A ROOM:

Fax the attached reservation request form to Conference Services at the fax number provided below. You may also call the number provided below and we can take your reservation over the phone. A Visa or MasterCard number must be listed to reserve your room. Charges will not be applied to your card until you check in.

Conference Services
 The Pennsylvania State University
 133 Johnston Commons
 University Park, PA 16802

Phone: 814-865-0079
Fax: 814-863-8877

Toll-Free: 800-778-8006

PAYMENT:

Accepted forms of payment for housing are cash, check, MasterCard or Visa. No other forms of payment will be accepted. If you are planning to pay for your room via credit card, the cardholder must present the card at time of check in. If this is not possible, you may guarantee your reservation by credit card, and pay with a check or cash at time of check-in. All housing charges must be paid in full at time of check-in.

CANCELLATION AND EARLY DEPARTURE POLICY:

Cancellation/No Shows: If you fail to cancel before July 27th, or do not show up for your lodging, a one-night lodging fee at the package rate will be charged to your credit card or deducted from your payment prior to refund or credit to account.

Early Departures: A "Refund Request" form, available at all check-in locations, must be completed at the time of your early departure, and all keys and cards must be returned to complete the check out process. You will be charged for the length of your stay, plus a one-night penalty.



North Halls Reservation Form

**SOCIETY FOR THE STUDY OF REPRODUCTION (SSR) 2012
 THE PENNSYLVANIA STATE UNIVERSITY
 ON-CAMPUS HOUSING RESERVATION REQUEST**

Guest's Name: _____

Address: _____
 Street Address

City _____ State _____ Zip Code _____

Phone Number(s): _____ Home/Cell

_____ Other

_____ Email Address

Roommate(s) request: If you would like to request a roommate(s) for the adjoining room, you may indicate below. If you do not designate a roommate, one will be assigned (gender same). Maximum occupancy per room is three (3) including a cot.

PLEASE INDICATE GUEST NAME(S) BELOW FOR YOUR ROOM	PLEASE INDICATE GUEST NAME(S) BELOW FOR ADJOINING ROOM
1). _____	1). _____
2). _____	2). _____
3). _____	3). _____

Arrival Date:

Departure Date:

Number of Nights: X \$60.00 per night, per room = \$

Number of Nights: X \$45.00 per night, per room = \$

Number of Rooms:

Number of Nights (Cot): X \$20.00 per night, per room = \$

Total = \$

Parking Pass: Yes No (\$21)

Directions to campus and maps are available at <http://www.campusmaps.psu.edu/>.

Acceptable forms of payment are: cash, check, MasterCard or Visa. No other forms of payment will be accepted. If using a card to pay for accommodations, the cardholder and card must be present at time of check-in. Guests may reserve a room via credit card and pay with alternate means at time of check-in if cardholder cannot be present.

We hope you enjoy your stay with us! Please let us know if we can be of any further assistance.

Charge to: Visa MasterCard

Card Number: _____ **Expiration Date:**

Cardholder Name: _____
Type or Print Clearly

Signature: _____ **Date:**